

## Wireless (outdoor) infrared detectors

CT70

Anti-pet type

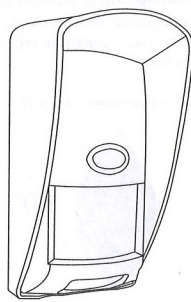

Master the core technology,  
popularize safe cities

### I. Introduction to product

Welcome to use the "new generation" (wireless outdoor type) pet immunity infrared intrusion detectors. It adopts importer super low power consumption digital microprocessor, random dynamic time division and energy accumulation logic processing technology, patented precision columnar Fresnel lens, Using high intelligent volume recognition + outdoor filter + dual infrared + processor technology, adjustable pulse counting. Working with advanced patented software technology, it features super detection performance and judges the real invader truly and can overcome the shortcoming of false alarm, failed alarm and not alarm.

### II. Characteristics

- Using high intelligent volume recognition+outdoor filter+dual infrared+processor technology;
- Microprocessor with super low power consumption The use of general 5 batteries for more than 2 years, easy to buy, no need to change the battery;
- Dual temperature compensation technologies
- Adoption of detection technology of reflective mirror: overcome the shortcoming of traditional detector that does not alarm for crawling in
- The technology of adjustable pulse counting
- Dual induction technology
- Time division technology with random dynamic
- Fresnel optical lens + Volume identification can prevent mistaken alarm and omitted alarm
- Detection distance: 6-9m

- Detection angle: 110°
- Transmission mode: Wireless 433.92mhz (1527)
- The design of wall mounted and unique plug type installation
- Pet immunity: 25KG

**Note: the use of outdoor installation must be firmly installed; quiet location;**

### III. Appearance introduction

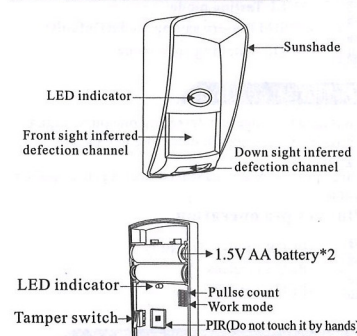

### IV. Considerations for installation

⚠ Please pay attention to the following condition to avoid that it cannot be used normally.

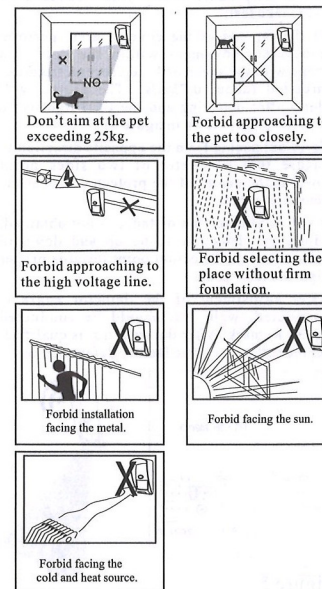

### V. Installation and immunity

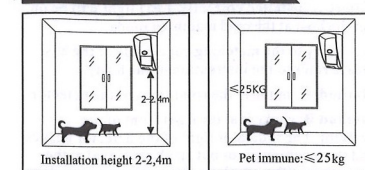

⚠ Determine the detection of the detector and immunity of the pet according to the height and angle.

#### About the installation height

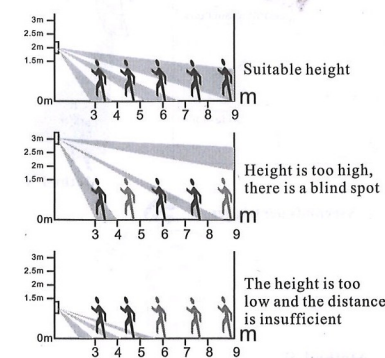

### 5.1 Install the battery

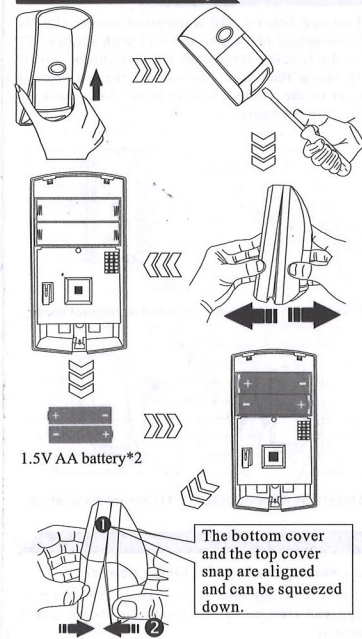

### 5.2 Bracket mounting

Mounting bracket and waterproof cover: (1) Fix the mounting bracket to the wall with screws; (2) Fix the bracket screw and the waterproof cover; (3) Move the inner bayonet of the waterproof cover to the product port to move downward; as shown in the figure.

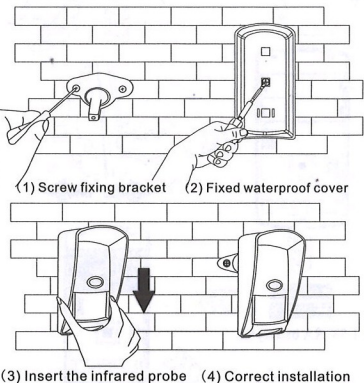

### VI. Work mode and pairing of the detector

**6.1. Normal work mode (saving power):**  
After CT70 detector is triggered, the alarm is triggered after automatic interval of more than 5 seconds.

**6.2. The pairing method with the host:** after the battery is installed correctly, LED light will be on. Set the host at the cold matching mode.

(For entry to the matching code mode of the host, please refer to the instruction of the host).

**Method A:** move at the right front of the detector.

**Method B:** shake it at the right front of the detector. The indicator light of the detector flashes and the machine gives out an alarm signal at the same time. When the host gives out corresponding prompt sound, indicate that match coding is successful.

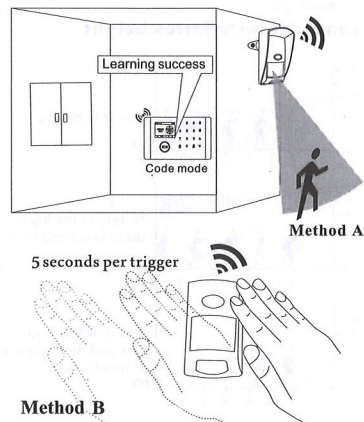

### VII. The method to make test in the covered area

- Adjust the product to the optimal direction so as to make test;
- At the far end of the covered area, perform transverse movement within the detection scope with the speed of 1 step/second from any direction (about 0.75m/s). The protect will alarm after detecting and the LED light is on for 3 seconds (shown in figure 5)
- Carry out pacing from the opposite direction to ensure that perimeter of two sides point towards the center of the protected area at the detection center.
- If the ideal detection distance is not obtained, adjust the detection scope up and down to ensure that the detection point towards proper high and low scope.
- After adjustment of the detector angle is completed, walk test should be conducted again. Remark: After the walk test is qualified, set the test mode to the factory default mode.

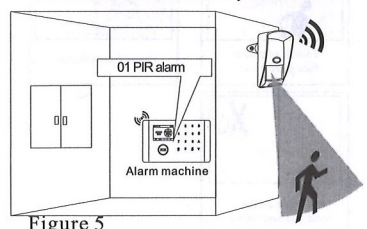

### VIII. Working mode setting

- Detection mode: after the detector is triggered, it cannot be triggered for alarm unless the interval is more than 5 seconds.
- Battery saving mode: Interval time of making alarm is three minutes
- Code Mode: Pressing the tamper button lasting three seconds to send an identifier to rece

#### Plunger pin operation

- FULL Testing mode
- NORM Battery saving mode(Default)
- CODE matching code mode

### IX. Pulse setting

1 pulse: Alarm against detecting one pulse signal  
2 pulses: Alarm against detecting two pulses signal  
Three pulses: Alarm against detecting three pulses signal

#### Plunger pin operation

- PLUS 1 pulse (Default)
- PLUS 2 pulses
- PLUS 3 pulses

### X. Clearing and protection

The detector may be polluted with dirt after long-term use. At the moment, wet cloth may be used to wipe. Plenty of water is not allowed. Otherwise, the water may penetrate into the inside of the box cover, which may result in burnout of circuit.

### XI. After-sale service

11.1. Although our products have stable function, due to the limitation of its low pressure and use scope, we cannot guarantee that the alarm condition occurred in any condition can trigger the main body to give out alarm or not to give out alarm. The following is some common phenomenon.

- When the supply voltage of the detector is not sufficient, the product does not provide detection output alarm. Please check the power supply.
- When installation environment of the detector results in mistaken alarm and not alarm, please inspect environmental temperature and surrounding interference measures.

### XII. Installation

Installation height: 2.2-2.7m;  
working temperature: -20-50  
Storage temperature: -20-60  
Anti-visible light interference: larger than 6500LUX (indoors);  
Overall dimension: 120\*62\*46mm;  
cover: 135\*35\*70mm

### XIII. Specification

- Working voltage: 3V (1.5V AA battery\*2)
- Working current: 15mA
- Standby current: <9μA
- Maximum coverage area: 12m×12m
- Alarm indicator light: dual-color indicator light (green)
- Working environment: outdoor / indoors
- Anti-dismantling switch: normally close;
- Transportation mode: Wireless 433
- Alarm output: alarm condition report and anti-dismantling report

Detection area (shown in figure 2)

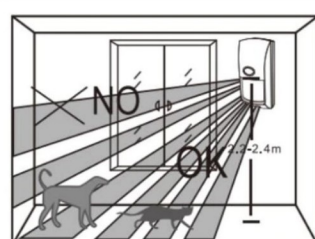
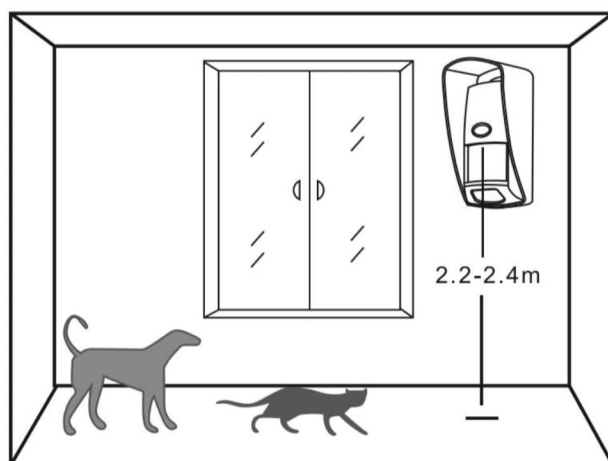
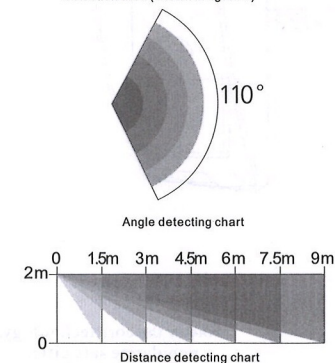

The top part of detection area is non pet-immunity area

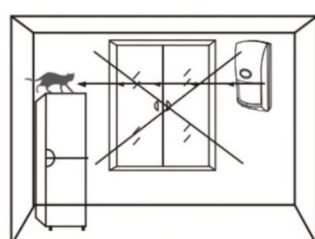

Never face the detector to the place that pets can climb up directly

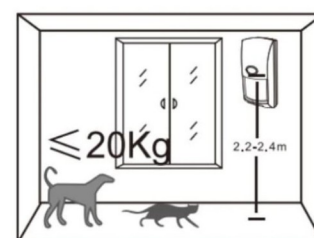

Pet immunity: <=20Kg pets

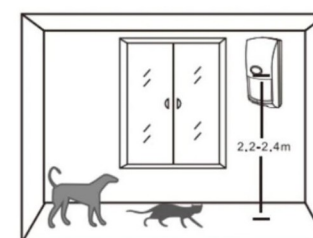

Pet immunity installation height 2.2-2.4m

