

# Wireless Keypad User Guide

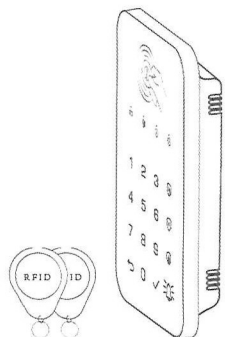

## WELCOME

This product is a wireless touch keypad that arms and disarms your security system with a passcode or RFID tag. It is connected to your alarm hub via the eV1527 protocol, with an effective communication range of up to 80 meters without obstacles. The internal lithium-ion rechargeable battery provides power operation up to 3 months.

## SPECIFICATIONS

Power Supply: Micro USB+5VDC/1000mA  
Backup Battery: 3.7V, 500mAh Lithium-ion Battery  
Consumption: <15uA@sleep and <15mA@ready  
Radio Frequency: 433Mhz  
RFID Chip: 4100/4200  
RFID Frequency: 125KHz  
Operation Temperature: -10~53°C

## IN THE BOX

Keypad x1  
Mounting Screws x2  
User Guide x1  
Power Adapter (Optional)  
USB Cable (Optional)  
RFID tag (Optional)

## ABOUT KEYPAD

### Sleep/Wake mode

To save the battery power, the keypad goes to sleep without operation within 20 seconds.

Touch any button to wake the keypad.

### User and Admin Passcode

The keypad has two 4-digit passcodes. The user passcode is used to arm, home arm and disarm your security system, the admin passcode can be used to pair, delete RFID tags and change passcodes. The default user passcode is "1234" and admin passcode is "8888".

## PROGRAMMING

### Basic programming steps

**STEP 1.** Enter admin passcode then √, the setting indicator lighting on means that programming mode is ready.

**STEP 2.** Input number to select functions:

- 1 Pair RFID Tag
- 2 Delete RFID Tag
- 3 Delete All RFID Tags
- 4 Set User Passcode
- 5 Set Admin Passcode

then √, the setting indicator blinks.

**STEP 3.** Enter setting then √, the buzzer beeps twice.

**LAST STEP.** Press ← then √ to exit programming.

### Pairing RFID Tag

The RFID tags supplied with this kit are paired with keypad. IF NOT or you want to pair more, you might easily pair the tag with your keypad as following.

**STEP 1.** Enter admin passcode then √.

**STEP 2.** Press 1 then √.

**STEP 3.** Enter a digit from 0 to 9 to designate a unique number for the tag to be paired, then √, the arming, disarming and setting indicators blink together.

**STEP 4.** Tap the tag on the read zone, the keypad gives two beeps of successful indication.

*Tips:* up to 10 RFID tags can be added.



### Deleting RFID Tag

**STEP 1.** Enter admin passcode then √.

**STEP 2.** Press 2 then √.

**STEP 3.** Enter the tag number from 0 to 9 to be deleted, then √.

### Deleting All RFID Tags

**STEP 1.** Enter admin passcode then √.

**STEP 2.** Press 3 then √ to delete all RFID tags.

### Setting User Passcode

**STEP 1.** Enter admin passcode then √.

**STEP 2.** Press 0 then √.

**STEP 3.** Enter the new 4-digit user passcode, then √.

### Setting Admin Passcode

**STEP 1.** Enter admin passcode then √.

**STEP 2.** Press 9 then √.

**STEP 3.** Enter the new 4-digit admin passcode, then √.

## AT A GLANCE

1. RFID tag reader zone
2. Power/Ready indicator
3. Away/Home arming indicator
4. Disarming indicator
5. Setting indicator

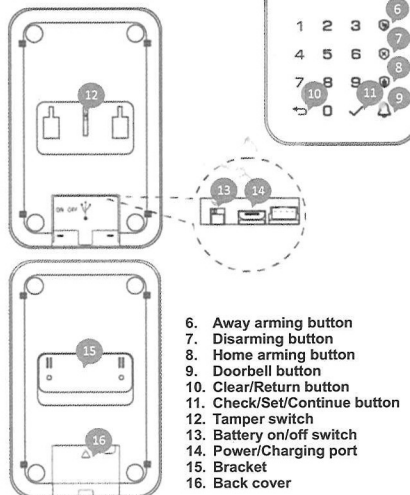

6. Away arming button
7. Disarming button
8. Home arming button
9. Doorbell button
10. Clear/Return button
11. Check/Set/Continue button
12. Tamper switch
13. Battery on/off switch
14. Power/Charging port
15. Bracket
16. Back cover

## HOW TO CONNECT YOUR KEYPAD TO HUB

**STEP 1.** Set your hub into pairing/sniffer mode.

**STEP 2.** Enter user passcode then press → to send arming transmission signal to hub.

**STEP 3.** The hub gives the successful indication.

## DOORBELL

The doorbell identification number in transmission code to the hub is different from the arming/disarming id number, so it is necessary to pair doorbell code with your hub before using doorbell. Do like the following:

**STEP 1.** Set your hub into pairing/sniffer mode.

**STEP 2.** Press → to send doorbell transmission signal to hub.

**STEP 3.** The hub gives the successful indication.

Now the doorbell function can be used.

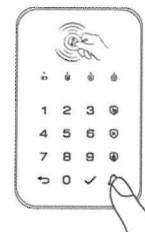

## Power/Ready indicator

What you see	What it means
Blinking red	Battery failure or battery switch is off
Flashing red once per 2s	Low battery
Solid red	Ready
Breathing green	Charging
Solid green	Charged fully

## CHARGING THE BATTERY

Push the battery switch to on. Connect your keypad to a power outlet using the included cable and USB power adapter.

It takes two to three hours to charge the keypad battery fully from an empty state. The power indicator turning from breathing green to solid green means that the battery is fully charged.

If the keypad is low battery, the power indicator may flash red once per 2 seconds, indicating that it needs to charge.

## INSTALLATION

Before installation, please test the keypad communication range with your hub first.

It is not advised to mount the keypad onto metal surfaces as the material can block RF signals between the keypad and the receiver.

Fix the bracket to the surface with included screws. Insert the keypad into the bracket.

## ARMING/DISARMING YOUR SECURITY SYSTEM VIA KEYPAD

### Using User Passcode.

Enter user passcode then press → to away arm.

Enter user passcode then press ⊗ to disarm.

Enter user passcode then press → to home arm.

### Or Using RFID Tag.

Press → then tap the RFID tag to away arm.

Press ⊗ then tap the RFID tag to disarm.

Press → then tap the RFID tag to home arm.

## RESET

This process resets your keypad to factory settings and removes all RFID tags.

Press and release tamper switch found underneath the bracket ten times, then all indicators are on, then the keypad restarts.